

Energy Wall U-ERV™

Introducing the Universal ERV™, the First Fully Modular Energy Recovery Air Handling System

The Energy Wall® U-ERV™, is an innovative, **Modular**, energy recovery ventilation product designed to meet the growing demand for increased outside air, in an ultra-compact form factor. Units can be hand-carried, and configured on site. The U-ERV is the only plate-type ERV to match the performance of wheel technology, while economically providing durability, and an extended service life.

The U-ERV is Modular and Stackable from 600 CFM to 6000 CFM, with single power, control and duct connections. Detachable Fan-Cubes are positioned for most convenient installation

- *Cooling Option*
- *Dehumidification Option*
- *Factory or field assembled*



Carbon Infused Polypropylene Construction

Energy Wall® Design Innovations:

- **Patented Membrane**
 - High Performance Latent Transfer
 - Anti-Microbial
- **Patented ERV HX Core**
 - Fixed-Plate Type
 - Compact and Light
 - Highly Durable, No Moving Parts
 - 70% Total Efficiency by Intertek
- **Highly Unique and Compact ERV Unit**
 - 4X Smaller than Competitive Units
 - Modular and Stackable
 - Exterior or Interior Applications
 - Sensible or Enthalpy Models
 - Internal Economizer Damper
 - Up to 2" External Static!
 - Modulating Fan Speed Control
 - Configurable Duct Locations



Tel: 717-814-5365
Fax: 717-406-1918

1002 New Holland Ave.
Lancaster, PA 17601

Info@EnergyWall.com
www.EnergyWall.com

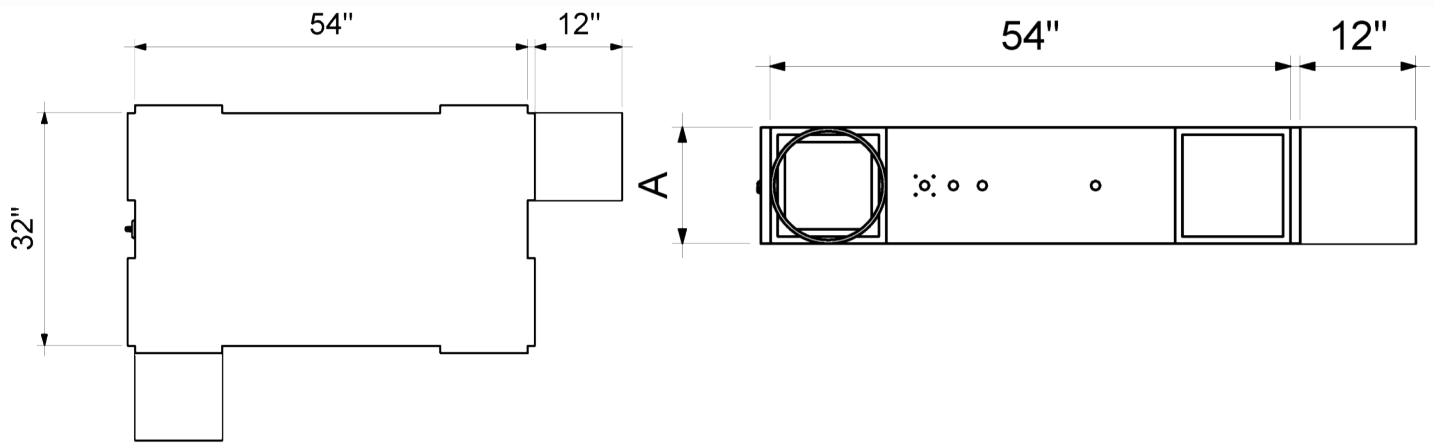

Model	Air Flow (CFM)	A (Height in")	B (Width in")	C (Depth in")
U-ERV-600	600	12	54	32
U-ERV-1200	1200	24	54	32
U-ERV-1800	1800	36	54	32
U-ERV-2400	2400	48	54	32
U-ERV-3000	3000	60	54	32
U-ERV-3600	3600	72	54	32
U-ERV-4200	4200	84	54	32
U-ERV-4800	4800	96	54	32
U-ERV-5400	5400	108	54	32
U-ERV-6000	6000	120	54	32



Tel: 717-814-5365
Fax: 717-406-1918

1002 New Holland Ave.
Lancaster, PA 17601

Info@EnergyWall.com
www.EnergyWall.com